

## TROUBLESHOOTING

If the nozzles or diverter fail to operate, first check the pump:

- Check to make sure the power cord is plugged in to a GFCI receptacle that has power running to it.
- Check to ensure it is fully submersed in water.
- Check to ensure the impeller and housing are clean.

If the performance is not satisfactory or the water does not flow evenly:

- Check the pump outlet and tubing, nozzles, features, spouting statues etc. for kinks or obstructions.
- Check the spray nozzles for obstructions or a loose connection

## LIMITED WARRANTY

These components are warranted to the original user against defective materials and workmanship for a period of 12 months. Our limited warranty does not cover any costs associated with the installation or removal of products subject to warranty claims or the cost of return. The warranty will commence from the date of purchase. Replacement liability is limited to any part or parts of the unit which have failed due to defective material or workmanship. Proof of purchase is required for all claims against the limited warranty. This warranty does not extend to damage of the product or part resulting from accident, misuse, alteration, neglect, abuse, improper installation or normal wear and tear to the product(s).

This limited warranty extends only to the original user of the product.

For more information on this and other products, please visit our web site:

[www.angelodecor.com](http://www.angelodecor.com)

**PLEASE DO NOT RETURN THIS UNIT TO THE STORE.**

To contact us regarding this unit, your options include:

Email: [customersupport@angelodecor.com](mailto:customersupport@angelodecor.com) | Phone: (780) 453 - 6646 | Fax: (780) 453- 6620

Angelo Décor International Inc. | 15840 – 118<sup>th</sup> Avenue | Edmonton, AB | T5V 1C4



AD42126

## FOUNTAIN NOZZLE KIT INSTRUCTIONS

### PACKAGE CONTENTS

01. Tiered Spray Nozzle
02. Dual Feature Diverter
03. Bell Spray Nozzle Head
04. Trumpet Spray Nozzle Head
05. Riser Tube Coupler
06. Threaded Mounting Adapter
07. Telescoping Extension Tube
08. Riser Tube (2)
09. Bell and Trumpet Nozzle Base
10. Foaming-Jet Spray Nozzle

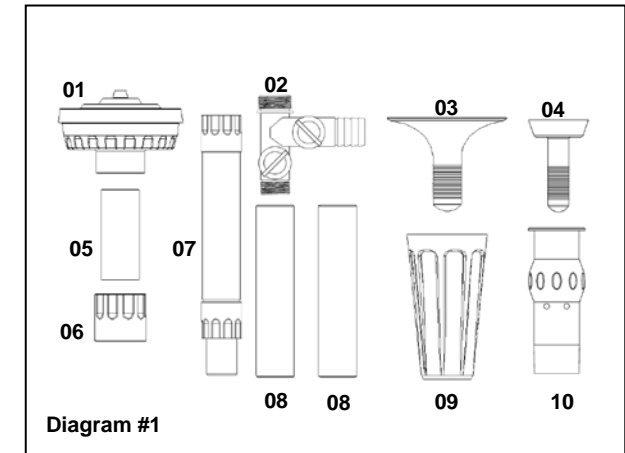

### THANK YOU FOR BUYING A POND BUILDING SERIES™ PRODUCT.

Please note, these items are primarily intended for use with our *Pro Grade Pump Series*:

AD40600 (600GPH), AD40800 (800GPH), AD41001 (1000GPH), AD41500 (1500GPH)

As well as our AD40402 (400GPH) Fountain/Pond Pump

It is also compatible other brands of pumps with a 3/4" male output.

### IMPORTANT! - BEFORE YOU BEGIN

We strongly recommend the use of a filter box for use in any pond application.

Fountain Nozzles work best in a clean pond environment.

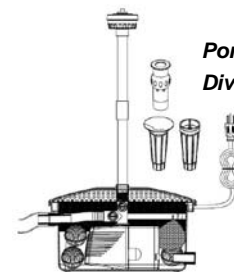

Diagram # 2

*Pond Filter Box 600 with 400gph pump,  
Diverter, and Tiered Nozzle*

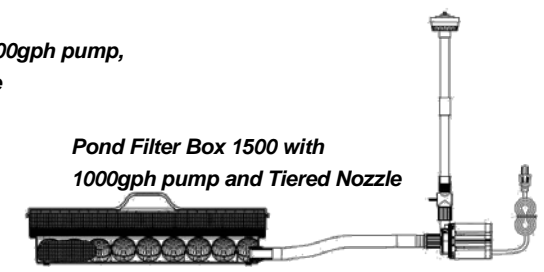

Diagram # 3

*Pond Filter Box 1500 with  
1000gph pump and Tiered Nozzle*

Please visit our website ([www.angelodecor.com](http://www.angelodecor.com)) for more information and videos on how to assemble and properly use your product.

## ASSEMBLY INSTRUCTIONS

- Identify the height of riser required to feature the nozzle at the desired level in your pond. Choose the riser assembly that best suits your needs.
- Review the parts list (diagram #1), as well as any included parts with your pump (sold separately), to determine what you will need to properly mount the chosen assembly to your pump.
- See the outer packaging of this product for performance details on the included fountain nozzles. These four popular spray patterns provide you visual and functional options that suit most pond sizes and environments.

### PRIMARY USES:

#### Single Feature use, with Flow Control

- Attach threaded mounting adapter (06) to the pump output.

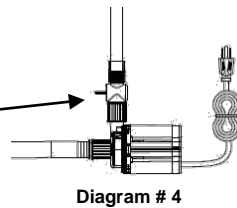

Diagram # 4

- Attach 1 or 2 riser tubes (8), and your choice of Fountain Nozzle.  
Note: If using telescoping riser, this adapter is not needed. Direct mount the riser to the assembled pump outlet.

#### Dual Feature use, Fountain nozzle With Spouting Statue or Waterfall (not supplied)

- Based on the pump used in your application, the diverter can be attached either directly to the pump, or to an adapter coupling supplied with the pump.
- Use  $\frac{3}{4}$ " ID Tubing (not supplied) to attach to your water feature.

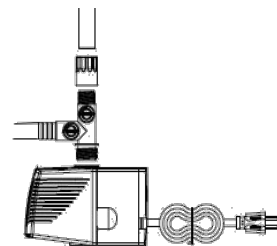

Diagram # 5

#### Dual Feature use, continued

- The Various riser tube options can mounted using the same methods described in Diagram #4
- The diverter features a dual-flow control. Each feature (spray nozzle and water feature) can be adjusted independently of the other as needed.

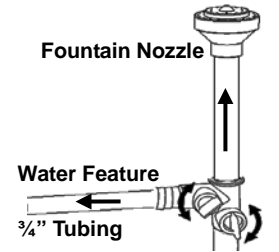

Diagram # 6

#### Fountain Nozzle Head Assembly:

- Spray nozzle heads should be assembled as shown in Diagram #7.

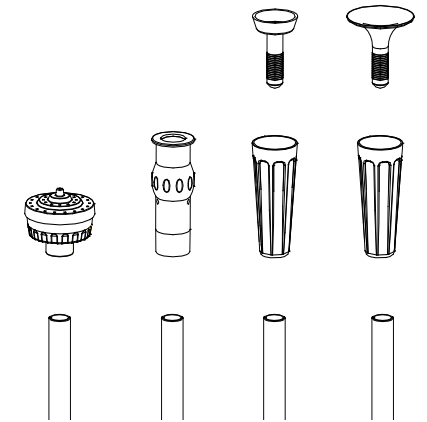

Diagram # 7

Please Note: Trumpet and Bell Nozzle share the same base unit. The feature piece is threaded into the base to allow easy adjustment of the water spray appearance and diameter.

### ALWAYS PLUG IN YOUR PUMP TO A GFCI RECEPTACLE

#### CARE AND MAINTENANCE

- Before cleaning, always disconnect the pump from the power supply and remove from pond.
- Clean the components when they are visibly soiled or when a drop in performance is detected.
- Use a cloth or soft brush with warm, soapy water when cleaning.